

ROUTE 1

GROUND FLOOR (RUSSIAN FLOOR 1)

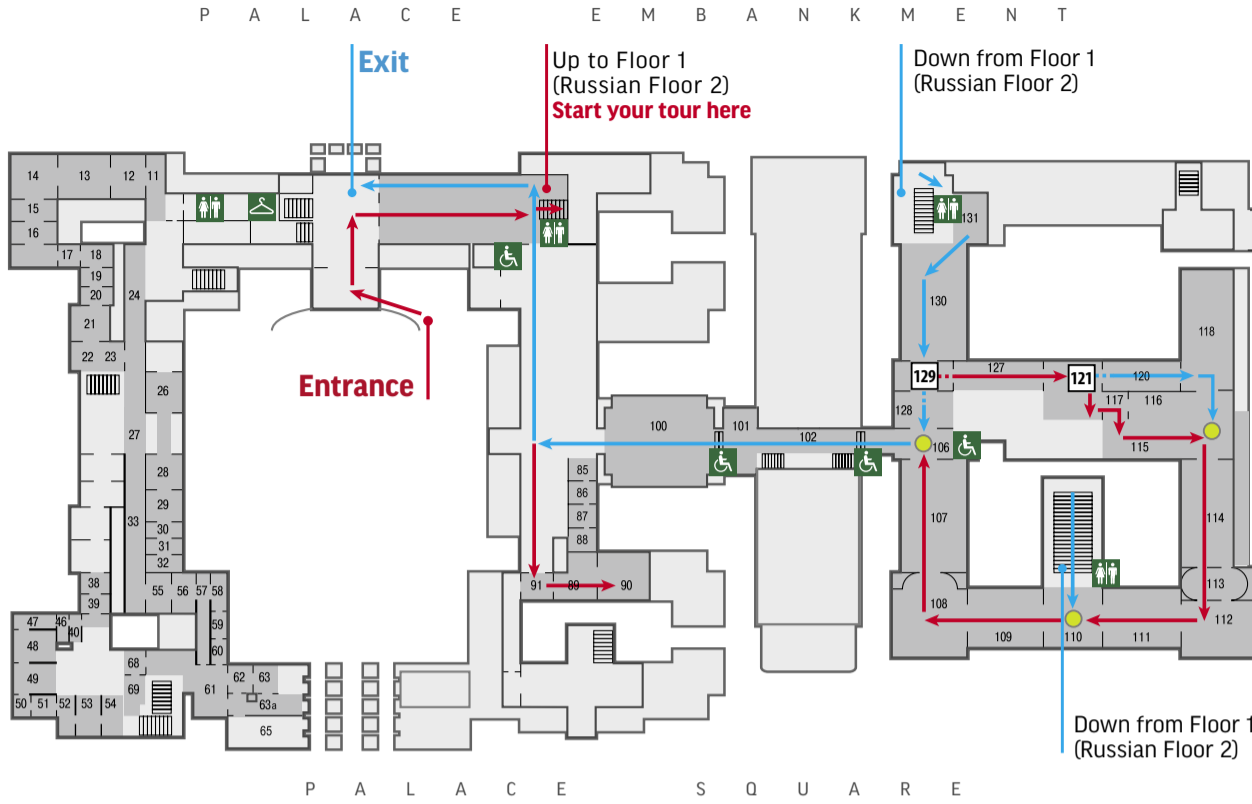

NUMBERS INDICATE THE ROOMS WHERE YOU CAN CHOOSE BETWEEN THE ROUTES.

COLOURED ARROWS INDICATE ROUTE DIRECTIONS.

- 193**
 - ▶ THE SUITE OF STATE ROOMS
 - ▶ THE MINISTERIAL CORRIDOR • RUSSIAN ICONS
- 200**
 - ▶ RUSSIAN ICONS • THE PAVILION HALL
 - ▶ THE PAVILION HALL
- 206**
 - ▶ THE PICTURE GALLERY
 - ▶ DOWN TO GROUND FLOOR (RUSSIAN FLOOR 1)
 - ▶ THE ART OF CLASSICAL ANTIQUITY • ANCIENT EGYPT • EXIT

- 207**
 - ▶ LEONARDO DA VINCI
 - ▶ TITIAN

FLOOR 1 (RUSSIAN FLOOR 2)

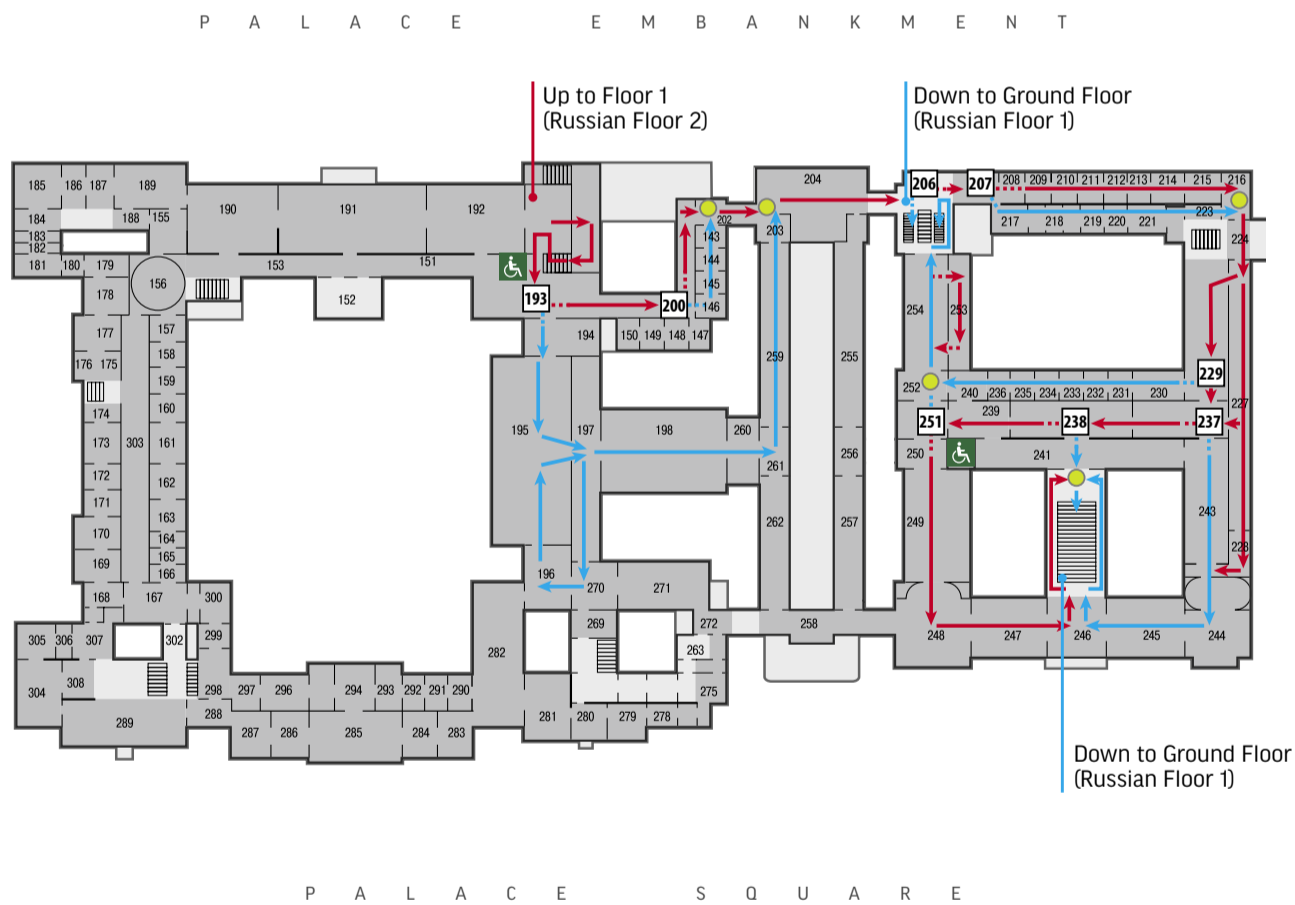

- 229**
 - ▶ THE KNIGHTS' HALL • ITALIAN ART • SPANISH ART
 - ▶ MICHELANGELO • ITALIAN ART • REMBRANDT

- 237**
 - ▶ THE KNIGHTS' HALL • SNYDERS • DOWN TO GROUND FLOOR (RUSSIAN FLOOR 1)
 - ▶ THE ART OF CLASSICAL ANTIQUITY • ANCIENT EGYPT • EXIT
 - ▶ ITALIAN ART • SPANISH ART • REMBRANDT • RUBENS

- 238**
 - ▶ SPANISH ART • REMBRANDT • RUBENS
 - ▶ DOWN TO GROUND FLOOR (RUSSIAN FLOOR 1)
 - ▶ THE ART OF CLASSICAL ANTIQUITY • ANCIENT EGYPT • EXIT

- 251**
 - ▶ DUTCH PAINTING • RUBENS • VAN DYCK
 - ▶ REMBRANDT • THE ART OF CLASSICAL ANTIQUITY • ANCIENT EGYPT • EXIT

- 129**
 - ▶ THE ART OF CLASSICAL ANTIQUITY • ANCIENT EGYPT • EXIT
 - ▶ ANCIENT EGYPT • EXIT

- 121**
 - ▶ THE HALL OF CARVED STONES • THE HALL OF VASES
 - ▶ THE ANTIQUITIES OF THE NORTHERN BLACK SEA AREA, FROM THE SEVENTH CENTURY BC TO THE THIRD CENTURY AD

000 NUMBER OF THE ROOM WHERE YOU CAN CHOOSE BETWEEN THE ROUTES



ROUTE DIRECTION



ROUTE CONNECTION POINT

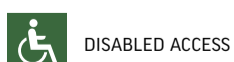

DISABLED ACCESS



TOILETS



CLOAKROOM